

CGA Guard Rope Pulleys

GUARD ROPE PULLEYS - CGA

The pulley wheels are made of galvanized steel and mounted on ball bearings; the pulley frames are made of galvanized steel. The pulleys can be supplied with three types of connections: fixed (B1) swivel-type (C1) or with hook provided with safety lock (D1).

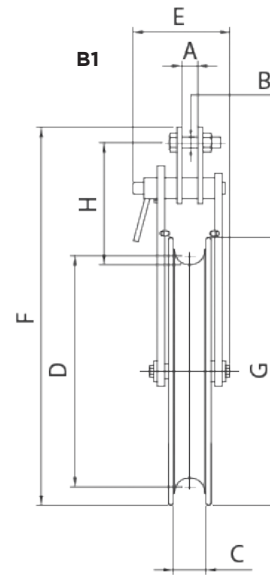
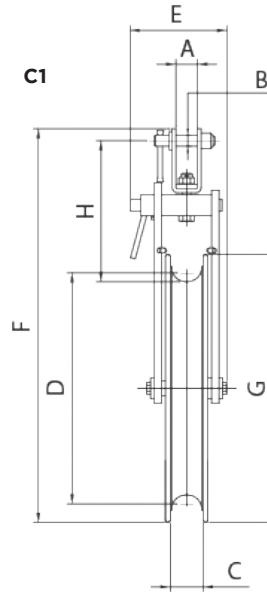
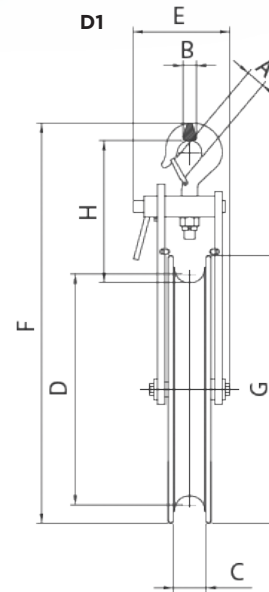
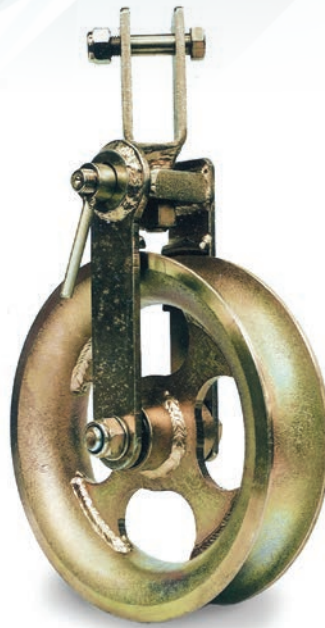

Model	Type of connection	Dimensions inches (mm)								Breaking load lbf (kN)	Mass lbs (kg)
		A	B	C	D	E	F	G	H		
21002010	B1	1 (26)	$2\frac{3}{32}$ (18)	$2\frac{9}{16}$ (65)	9 (230)	$5\frac{29}{32}$ (150)	$18\frac{7}{8}$ (480)	$11\frac{13}{16}$ (300)	$7\frac{1}{2}$ (190)	15,737 (70)	24 (11)
21002020	C1	$1\frac{3}{8}$ (35)	$2\frac{3}{32}$ (18)	$2\frac{9}{16}$ (65)	9 (230)	$5\frac{29}{32}$ (150)	20 (510)	$11\frac{13}{16}$ (300)	$8\frac{5}{8}$ (220)	15,737 (70)	24 (11)
21002030	D1	$1\frac{5}{16}$ (24)	$1\frac{3}{16}$ (21)	$2\frac{9}{16}$ (65)	9 (230)	$5\frac{29}{32}$ (150)	$18\frac{3}{4}$ (476)	$11\frac{13}{16}$ (300)	$7\frac{1}{4}$ (185)	15,737 (70)	24 (11)

